

*Designed*  
**around your life**



**IMPORTANT!**  
**KEEP THESE**  
**INSTRUCTIONS FOR**  
**FUTURE REFERENCE:**  
*READ CAREFULLY*

## Contents

<b>Product Information</b>	4
Warranty	
Contact	
<b>Child Usage Requirements</b>	5
<b>Warnings</b>	6
<b>Parts List</b>	10
<b>Product Set up</b>	12
<b>Product Use</b>	16
<b>Accessories</b>	26
<b>Care and Maintenance</b>	34

## Product Information

**Model Number:** \_\_\_\_\_

**Manufactured Date:** \_\_\_\_\_

The model number and the manufactured in date are located on a label on the stroller frame.

### Warranty

Our goods come with guarantees that cannot be excluded under the Australian Consumer Law. You are entitled to a replacement or refund for a major failure and compensation for any other reasonably foreseeable loss or damage. You are also entitled to have the goods repaired or replaced if the goods fail to be of acceptable quality and the failure does not amount to a major failure.

We have purposely designed our high-quality products so that they can grow with both your child and your family. Because we stand by our product, our gear is covered by a custom warranty per product, starting from the day it was purchased. Please have the proof of purchase, model number and manufactured in date available when you contact us.

**For warranty information please visit:**  
[www.nunababy.com](http://www.nunababy.com)

### Contact

For replacement parts, service, or additional warranty questions, please contact our customer service department.

**Distributed by Nuna Baby Australia Pty Ltd**

ACN: 642 240 140

Unit 1, 35 Lyn Parade Prestons, NSW Australia 2170

**For after-sales & warranty service, contact:**

1800 951 070

[customerservice@nunababy.com.au](mailto:customerservice@nunababy.com.au)

## Child Usage Requirements

This stroller is suitable for use with children who meet the following requirements:

**Weight:** up to 22.7 kg maximum

When using the stroller frame with LYTL bassinet or KLIK plus infant carrier, refer to the child usage requirements listed in those instruction manuals.

**LYTL bassinet**

Weight: up to 9 kg maximum

**KLIK plus infant carrier**

Weight: up to 13 kg maximum

# **WARNING**

**FOLLOW THE MANUFACTURER'S INSTRUCTIONS. PUT ON ALL THE BRAKES WHENEVER YOU PARK THE STROLLER.**

**DO NOT LEAVE CHILDREN UNATTENDED. ALWAYS KEEP CHILD IN VIEW WHILE IN STROLLER.**

**DO NOT USE THE SEAT WITH ANY OTHER MODELS OF STROLLER.**

**USE THIS HARNESS AT ALL TIMES.**

**DO NOT CARRY EXTRA CHILDREN OR BAGS ON THIS STROLLER.**

**MAKE SURE CHILDREN ARE CLEAR OF ANY MOVING PARTS IF YOU ADJUST THE STROLLER. OTHERWISE THEY MAY BE INJURED.**

**TO AVOID SERIOUS INJURY FROM FALLING OR SLIDING OUT, ALWAYS USE THE HARNESS CORRECTLY.**

**USE THIS TETHER STRAP TO STOP THE STROLLER ROLLING AWAY.**

**DO NOT USE THIS BASSINET ONCE THE CHILD CAN SIT UP UNAIDED.**

**DO NOT USE FOR UNSUPERVISED SLEEPING.**

**Ensure that all the locking devices are engaged before use.**

**Do not let your child play with this product.**

**Never leave the harness buckled when not fitted to a child in the stroller because the harness can form loops which may pose a strangulation hazard.**

**The use of accessories not approved by the vehicle manufacturer is unsafe.**

**Adult assembly required.**

**Use of this stroller with a child weighing more than 22.7 kg will cause excessive wear, and stress on the stroller, and could create an unstable condition. Use the stroller with only one child at a time.**

**To prevent a hazardous, unstable condition, do not place more than 10 kg in the storage basket before use.**

**To prevent a hazardous, unstable condition, do not place more than 0.45 kg in the storage pocket on the back of the seat.**

**To prevent a hazardous, unstable condition, do not place more than 0.45 kg in the cup holder.**

**Overloading, folding incorrectly, or using component parts from other manufacturers may cause the stroller to be damaged, broken or unsafe. Please read the instruction manual carefully.**

**Please read all the instructions in the manual before using the product. Please save instruction manual for future use. Failure to follow these warnings and instructions may result in serious injury or death.**

**Safety belts and restraint system must be used correctly.**

Child may slip into leg openings and be strangled if the harness is not used.

Never use stroller on stairs or escalators.

The stroller is not to be used near an open fire or exposed flame.

Never allow your child to stand on the stroller or sit in the stroller with head toward front of stroller.

Never place the stroller on roads or dangerous area.

The vehicle is designed for use on flat or gently sloping surfaces and may be unstable on higher sloping and uneven surfaces, resulting in the possibility of the vehicle tipping over.

Do make sure all parts are assembled and fastened properly before using the stroller.

To avoid strangulation, do not place items with a string around your child's neck, suspend strings from this product, or attach strings to toys.

To prevent tipping, do not put anything on the handle. Always lift the child in and out of the stroller.

Do not lift stroller while child is in stroller.

Do not use storage basket as a child carrier.

To prevent tipping, never let child climb the stroller.

To avoid finger entrapment or injury to the body, use care when folding and unfolding the stroller.

Be sure the stroller is fully open or folded before allowing child near the stroller.

Check that the infant child restraint attachment device is correctly engaged before use.

To avoid strangulation, do make sure your child is clear from the canopy.

Discontinue using your stroller if it is damaged or broken.

Stroller to be used only at walking speed. This product is not intended for use while jogging.

To avoid suffocation, remove plastic bag and packaging materials before using this product. The plastic bag and packaging materials should then be kept away from babies and children.

This product is not suitable for running or skating.

Stroller designed to be used from birth shall recommend the use of the most reclined position for new born babies.

The parking device must be engaged when placing and removing children.

Please ensure that the storage latch has been properly locked, before lifting or moving the vehicle.

The vehicle is not to be used as an unsupervised sleeping environment.

The brakes must always be applied when the stroller is not moving.

# Parts List

Make sure all parts are available before assembly.  
If any part is missing, please contact local retailer. No tools are required for assembly.

- 1 Arm Bar
- 2 Post Adaptors
- 3 Canopy
- 4 Crotch Buckle pad
- 5 Insert
- 6 Seat Pad
- 7 Front Wheel
- 8 Shoulder Harness Pad
- 9 Buckle
- 10 Seat Release Button
- 11 Calf Support Adjustment Button
- 12 Storage Basket
- 13 Insert
- 14 Cup Holder

- 15 Drift Button
- 16 Handle Button
- 17 Tether Strap
- 18 Fold Button (in the middle of the Recline Adjustment Button)
- 19 Recline Adjustment Lever
- 20 Storage Pocket
- 21 Stroller Fold Strap (under the seat)
- 22 Storage Latch
- 23 Brake Lever
- 24 Rear Wheel
- 25 Rain Cover
- 26 Travel Bag

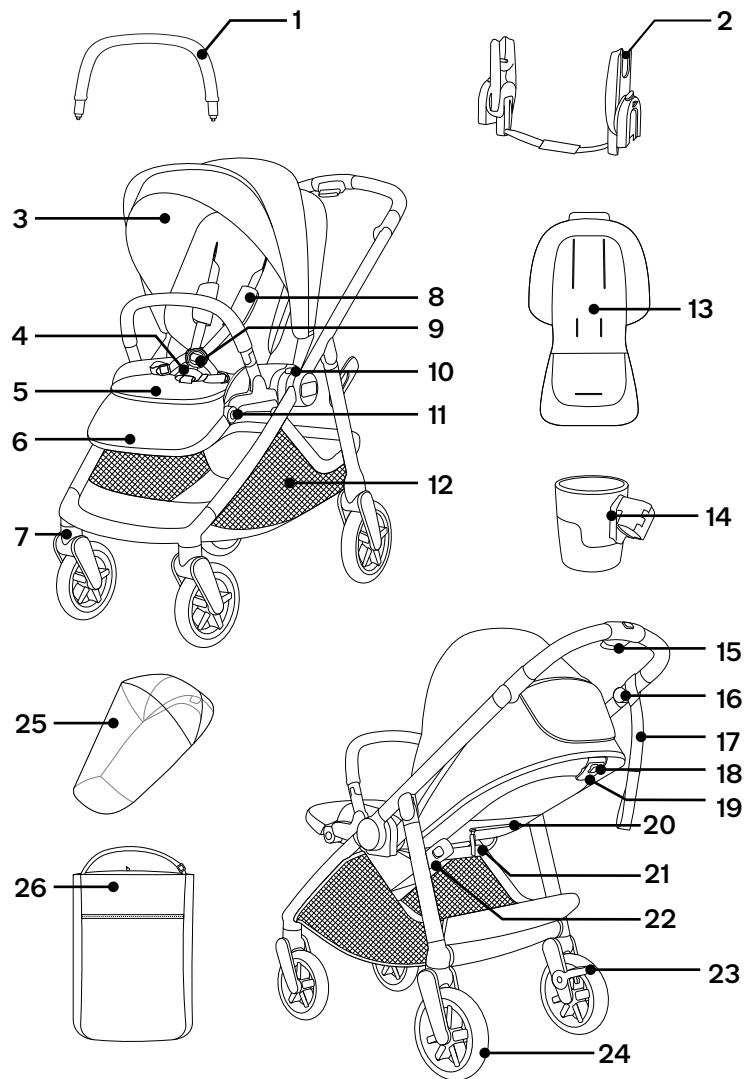

# Product Set Up

## Open Stroller

- 1 - Take the stroller frame out and then release the storage latch.
- 2 - Rotate the handle up to open the stroller frame.
- 3 - Pull the seat to open it (1) and press the middle of seat down (2).

! A “click” sound means the stroller frame is open.

! Check that the stroller is completely latched open before continuing.

## Insert

- 4 - To assemble the insert, push the center button on the buckle to release the buckle clasps, remove the clips and place the insert over the seat and thread the shoulder, waist and crotch harnesses through their respective slots.

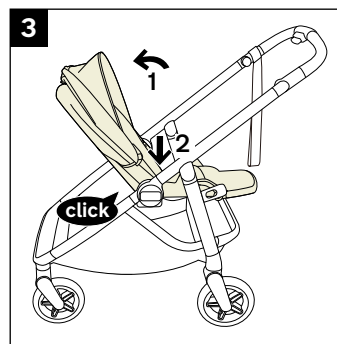
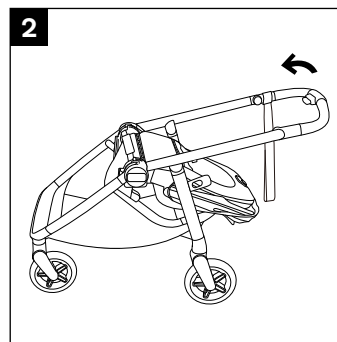
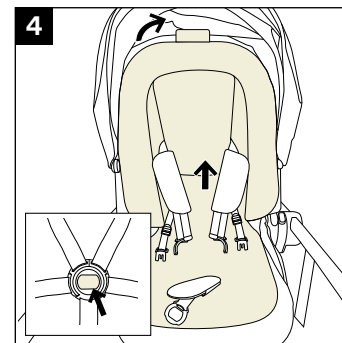
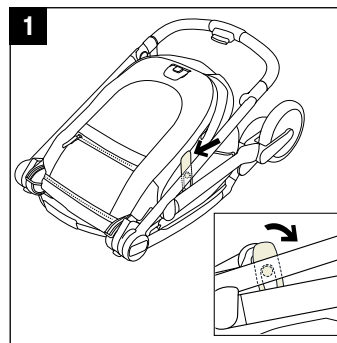

## Reverse Seat

- 1 - Press the seat release buttons.
  - 2 - Lift the seat up.
  - 3 - Reverse the seat, and then attach it to the frame.  
A “click” sound means the seat is attached completely.
- ! The parking brake **MUST** be engaged when the stroller is stopped and when placing and removing child.

## Arm Bar

- ! It is always recommended that the arm bar be used, but it is not a restraint device. Always secure the child with the harness.
- 4 - Align the arm bar ends with the arm bar mounts, and insert until it clicks into place. A “click” sound means the arm bar is assembled completely.
  - 5 - To remove the arm bar, press the arm bar release buttons (1) and lift the arm bar up (2).

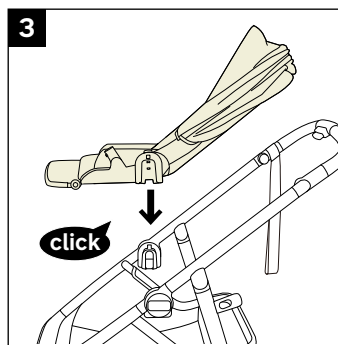
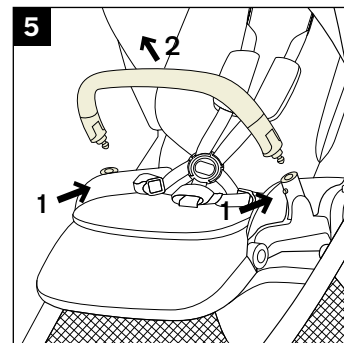
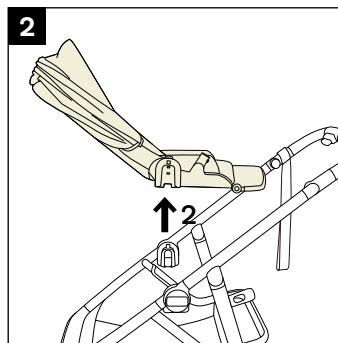
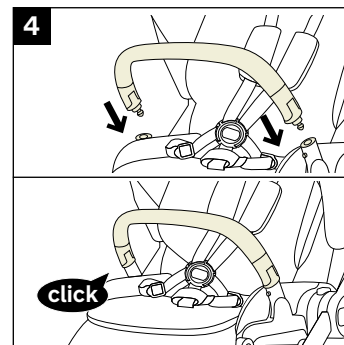
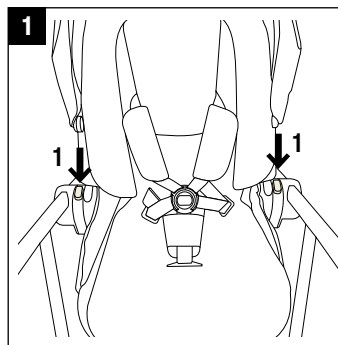



# Product Use

## Canopy

- 1** - To open the canopy, pull the canopy toward the front of the seat. To close the canopy, push it back.
- 2** - Unzip the zipper for extra shade.
- 3** - For added ventilation, flip the canopy window cover up.  
**!** Keep the zipper between the canopy and seat pad closed when stroller is in use.

## Calf Support

The calf support has 2 use positions.

- 4** - To raise the calf support, lift up.
- 5** - To lower the calf support, press the adjustment button (1), and push down (2).

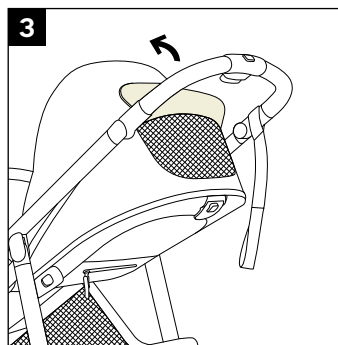
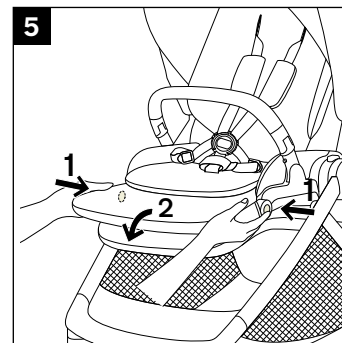
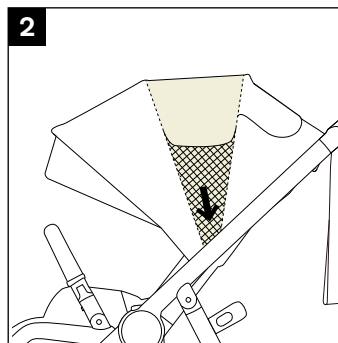
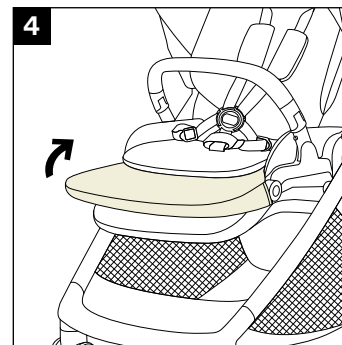
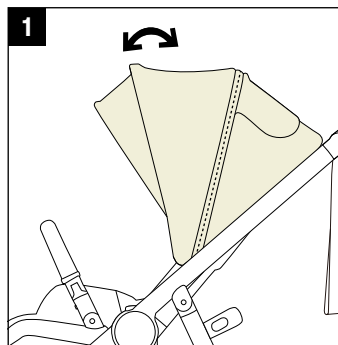

## Recline

There are 3 recline positions for the backrest. **USE** the most reclined position for new born babies.

- 1 - To raise or lower the backrest, squeeze the recline adjustment buttons (1), and pull the backrest up or down (2).
- 2 - Please do not press the button on the middle of the recline adjustment button when adjusting the angle for the recline.

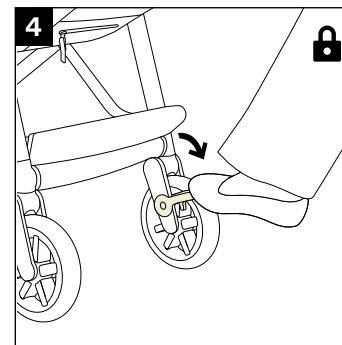
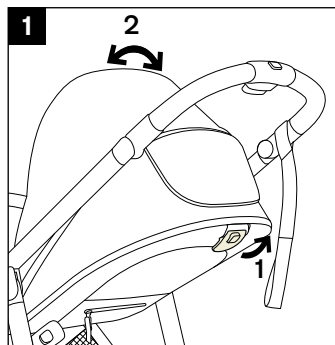

## Use Tether Strap

- 3 - Use the tether strap to prevent the stroller inadvertently rolling away. Check that when your hand is through the loop, it allows you to easily control the stroller.

! **WARNING:** Use this tether strap to stop the stroller rolling away.

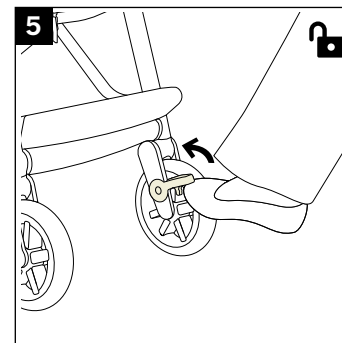
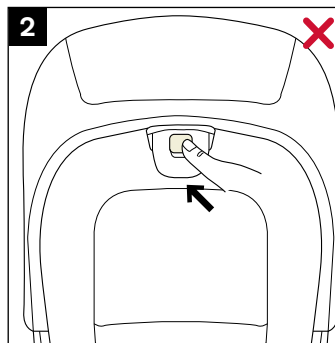

## Brake

- 4 - To lock wheels, step the brake lever downwards.
  - 5 - To release wheels, just lift the brake lever upwards.
- ! **ALWAYS** apply the brake when the stroller is stopped.

## Storage Pocket

- 6 - Use the storage pocket on the back of the seat for lightweight storage.
- ! To prevent a hazardous, unstable condition, **DO NOT** place more than 0.45 kg of items in the storage pocket.

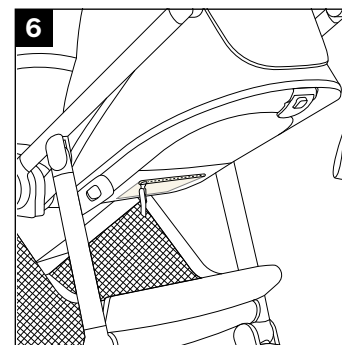
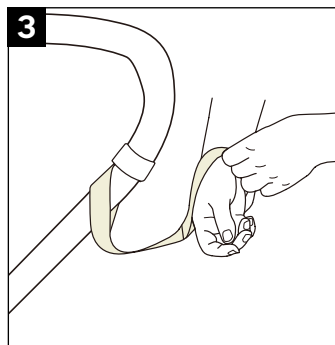

## Use Drift

- 1 - Press and hold the drift button to activate wheel rotation. (1) This allows the stroller to travel sideways and the rear wheels to swivel in any direction. Release drift button to resume forward/backward travel path.

! Only use the drift function on flat surfaces.

! After using the drift function, the rear wheels must return to their normal position. Push the stroller forward a short distance to allow the wheels to lock into place.

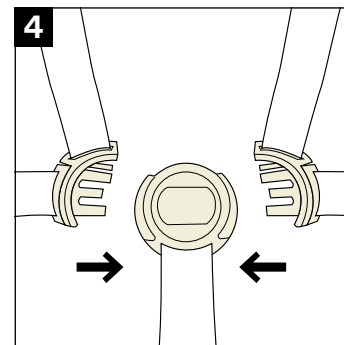
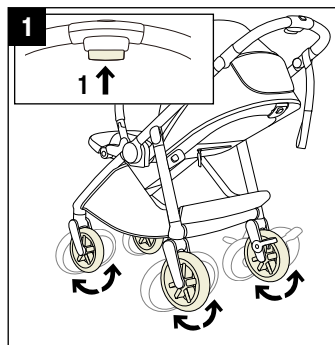

## Securing Your Child

! The parking brake **MUST** be engaged when the stroller is stopped and when placing and removing child.

! To avoid serious injury from falling or sliding out, always secure your child with the harness. Make sure the harness is adjusted properly and your child is snugly secured. The space between the child and the shoulder harness should be about the thickness of one finger. **DO NOT** cross the shoulder belts. This will cause pressure on your child's neck.

- 2 - Push the center button on the buckle to release the buckle latch, remove the clips and place your child in the stroller.

3 - Connect the shoulder buckle and hip buckle.

4 - Secure the shoulder buckle and hip buckle to the buckle latch and repeat on the opposite side.

5 - Fit the harness snugly to your child by pulling the adjustment straps to tighten (1). Then pull the waist adjustment straps out (2).

! **WARNING:** Use this harness at all times.

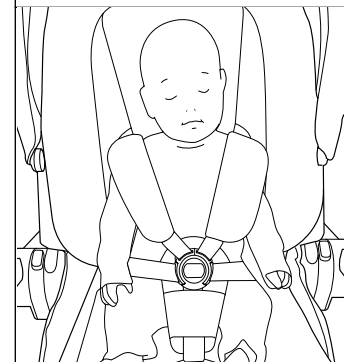
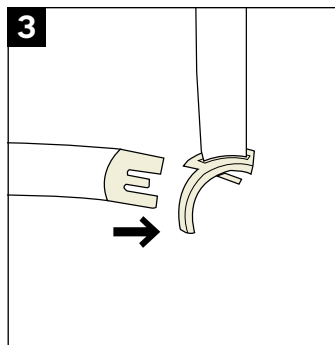
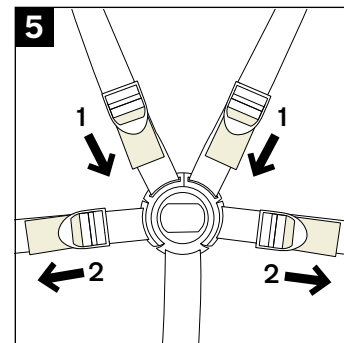
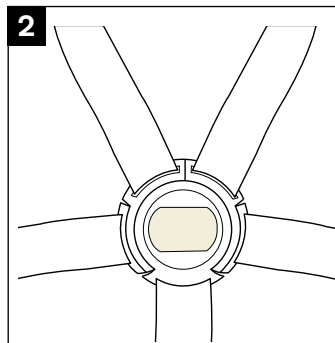

## Shoulder Harness Position

- 1** - The upper shoulder harness buckles can be moved up and down for correct shoulder height. Harness pad will move with the buckle.

Make sure the top of harness strap is adjusted to a height close to the top of child's shoulders. If too low or too high, the harness can slip off the shoulders and allow child to move out of position.

## Shoulder Harness Cover and Crotch Harness Cover

- 2** - The shoulder harness cover & crotch harness cover can be removed from the webbing.
- ! To assemble shoulder harness cover and crotch harness cover in reverse steps.

## Adjust Handle

- ! Handle can be adjusted to 3 positions.
- 3** - To adjust the handle, press the left and right handle adjustment buttons at the same time, and rotate the handle to a desirable position.
- 4** - Before folding the stroller, please adjust the handle to the second position. The stroller can stand after folding.

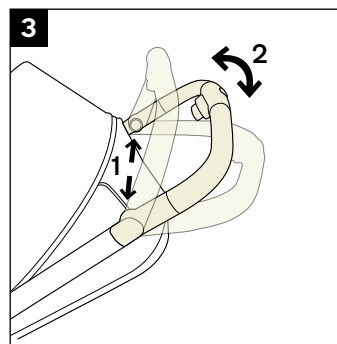
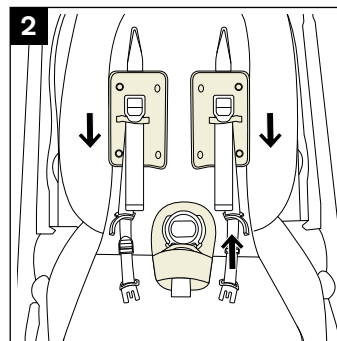
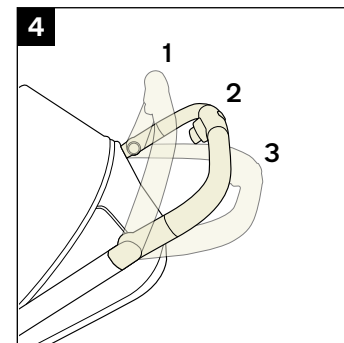
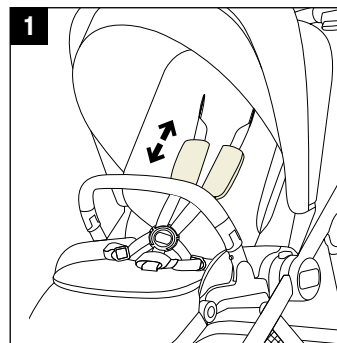

## Fold

### With Seat Attached

- ! Close the canopy and detach cupholder.
  - 1 - Press the fold button on the middle of the recline adjustment button, then pull the recline adjustment lever.
  - 2 - Fold the seat. Seat can be forward or rear facing.
  - 3 - Pull up the stroller fold strap to fold the stroller.
  - 4 - Rotate the storage latch. Secure the storage latch to the storage mount. The stroller can stand after folding.
- ! Keep clear of handle bar as it drops down, and keep clear of frame and seat as it folds down and inwards.
  - ! Stroller can free-stand with the handle bar in second position. Take care to balance stroller at a safe location.

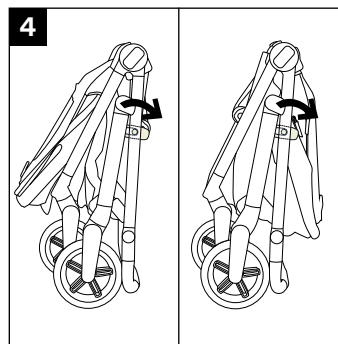
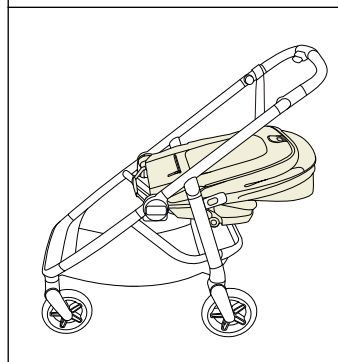
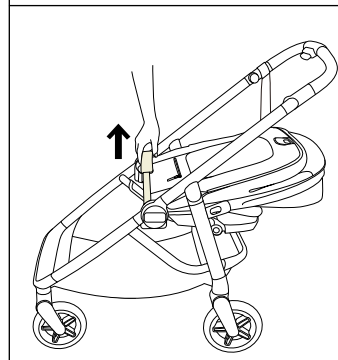
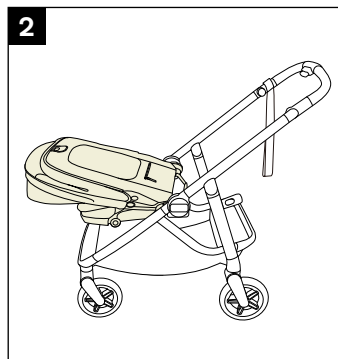
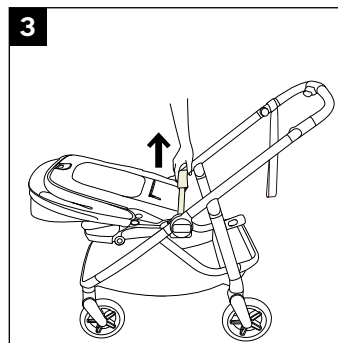
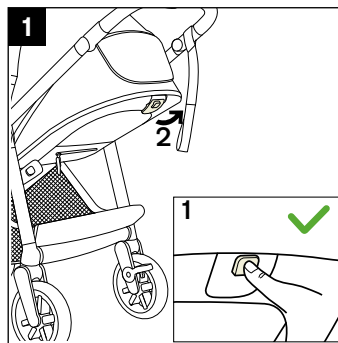

1 - You can carry the stroller by lifting its carry/fold strap.

- ! Ensure the storage latch is engaged when lifting or carrying the stroller.

### Without Seat Attached

- 2 - Fold the stroller without seat on it, press the folding buttons of the seat mounts.
- 3 - Fold the stroller and secure the storage latch to the storage mount. The stroller frame can stand after folded.

## Accessories

### Post Adaptors for Bassinet or Infant Carrier

- ! Do not use any accessories other than those approved for use with this stroller by the Nuna Baby.
- ! These instructions are for LYTL bassinet and KLIK plus infant carrier

For LYTL bassinet and KLIK plus infant carrier assembly and usage, please refer to the infant carrier and bassinet instruction manual.

- 4 - To attach the post adaptors, place the post adaptors on the seat mounts. A “click” sound means the post adaptors are attached.
- 5 - To attach infant carrier, place the infant carrier on the post adaptors. A “click” sound means the infant carrier is attached.

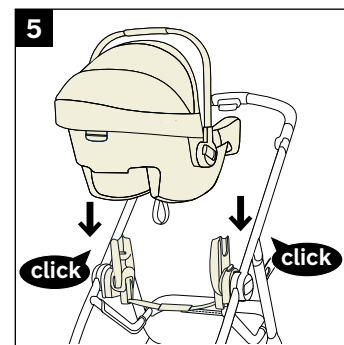
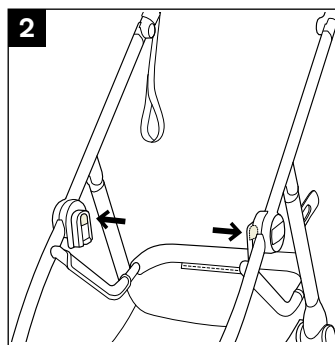
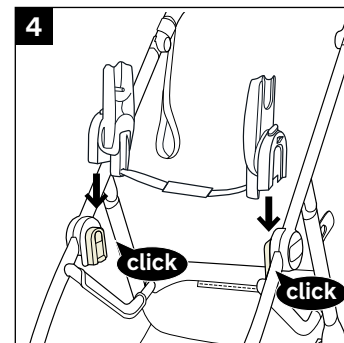
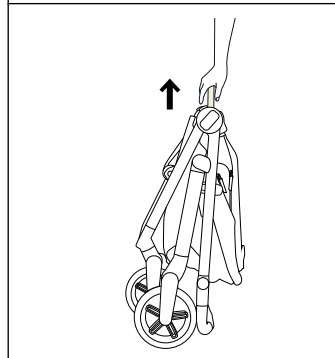
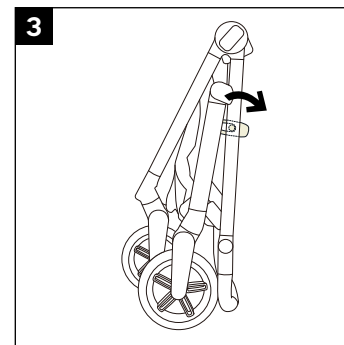
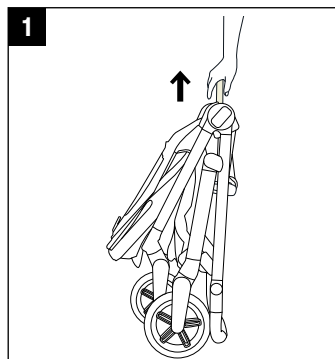

- 1** - To attach bassinet, place the bassinet on the post adaptors. A “click” sound means the bassinet is attached.
  - ! Check all locking devices are engaged correctly before use.
  - ! This vehicle is not be used as an unsupervised sleeping environment.
  - ! Always keep your child in view while in stroller.
  - ! Do Not use the bassinet once the child can sit up unaided.
- 2** - The infant carrier and bassinet can be used with rear facing.
- 3** - When used with rear facing, The letters on the post adaptors are the same as those on the frame plastic.

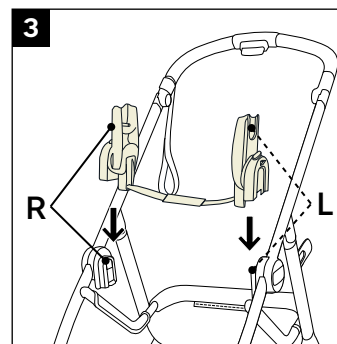
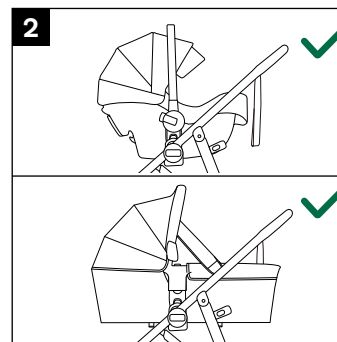
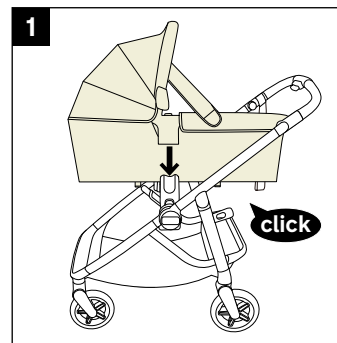

- 1** - To remove the infant carrier, push the release buttons on the infant carrier and lift up.
- 2** - To remove bassinet, press the release buttons on the side of the bassinet **(1)** and lift up **(2)**.
- 3** - To remove the post adaptors, press the adaptor release buttons **(1)** and lift up **(2)**.

### Fold the Stroller with Post Adaptors

- 4** - Pull the folding strap of the post adaptors to fold the stroller.
- 5** - Secure the storage latch to the storage mount. The stroller frame can free-stand with handle bar in second position.

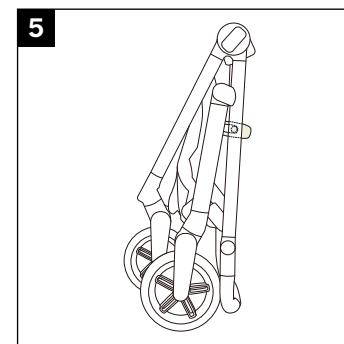
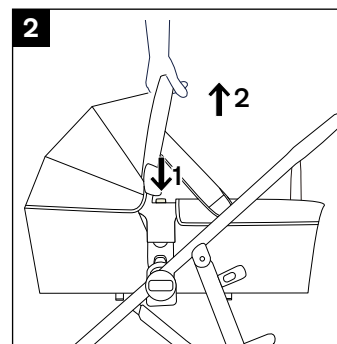
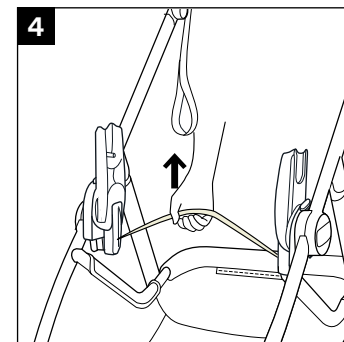
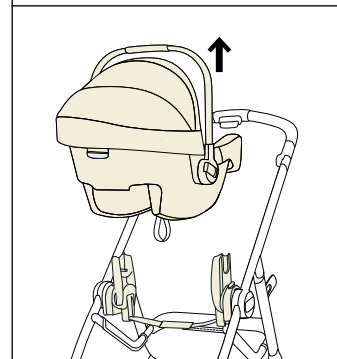
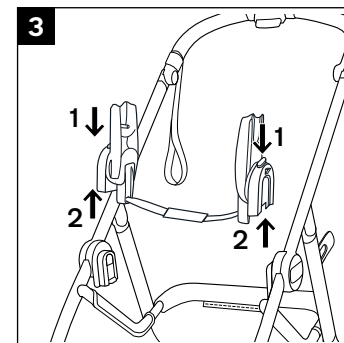
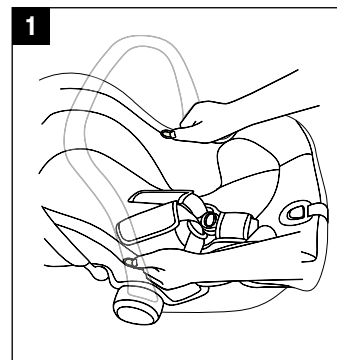



## Cup Holder

- 1 - To attach the cup holder, secure the right side of the cup holder clamp around the stroller handle, handle just below the leatherette pushbar.
- 2 - Rotate the left side of the clamp over the pushbar handle.
- 3 - Push the two pieces of the clamp together and listen for a “click”. A “click” sound means the cup holder is securely attached.
- 4 - To remove the cup holder, push apart the two pieces of the clamp and remove the cup holder from the pushbar.
  - ! Remove the cup holder before folding the stroller.

## Travel Bag

- 5 - Place the folded stroller into the bag with the wheels at the bottom, and close the bag by tightening the drawstring. The bag can be carried by the carry strap.

## Rain Cover

- 6 - To assemble the rain cover, place it over the stroller.
  - ! **ALWAYS** check ventilation when the rain cover is on the product.
  - ! **ALWAYS** check that the rain cover has been cleaned and dried before folding.
  - ! **DO NOT** fold the stroller with the rain cover in place.
  - ! **DO NOT** place your child into the stroller with the rain cover in place during hot weather.

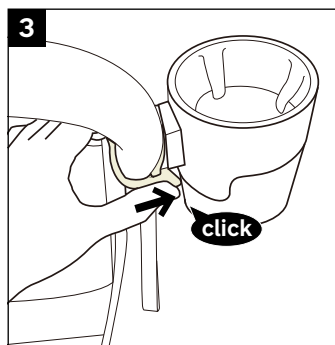
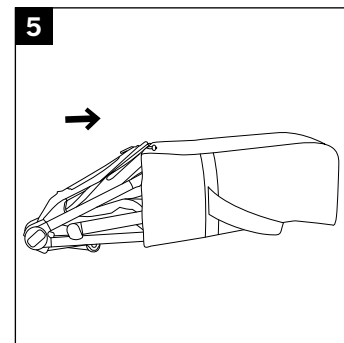
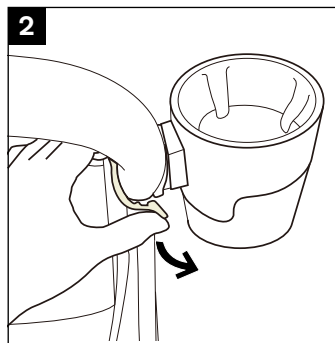
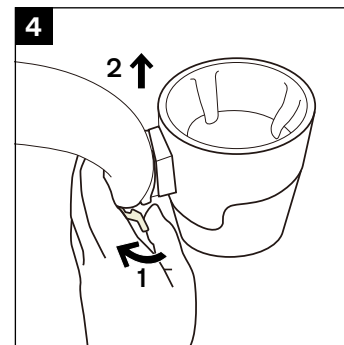
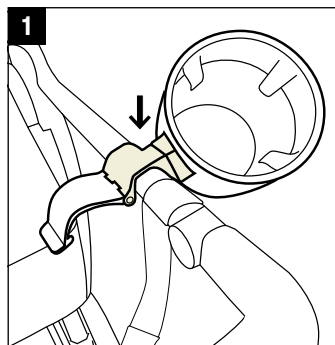

# Care and Maintenance

Clean the frame, plastic parts, and fabric with a damp cloth, but do not use abrasives or bleach. Do not use silicon lubricants as they will attract dirt and grime. Do not store your stroller in a damp place.

Clean the stroller wheels regularly with water and remove any dirt.

## To ensure long-lasting use:

- clear out debris, sand, hair, solids, etc from frame joints and wheels.

- wipe this product dry with a soft absorbent cloth after using it in rainy weather or from any spills.

Refer to the care label attached to the fabric for washing and drying instructions.

It is normal for fabric to color from sunlight and to show wear and tear after a long period of use, even when used normally.

For reasons of safety, only use original Nuna parts.

Check regularly if everything functions properly. If any parts are torn, broken, or missing, stop using this product.